

# COLLET

## ER 標準筒夾 (英制) ER Standard Collet (inch)

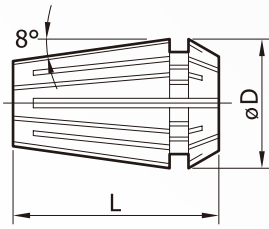

MODEL	øD	L	HP 級 (6µm)		AA 級 (10µm)		一般級 Normal	
			訂購編號 Order No.	夾持範圍 Range	訂購編號 Order No.	夾持範圍 Range	訂購編號 Order No.	夾持範圍 Range
ER8	8.5 (8.5)	13.6 (13.5)	ER8-1/16" HP	0.043"-0.063"	ER8-1/16" AA	0.043"-0.063"	-	-
			ER8-1/8" HP	0.105"-0.125"	ER8-1/8" AA	0.105"-0.125"	-	-
			ER8-3/16" HP	0.168"-0.188"	ER8-3/16" AA	0.168"-0.188"	-	-

• øD x L = 8.5 x 13.6 (HP/AA) | øD x L = 8.5 x 13.5 (A/ 一般級 Normal)

MODEL	øD	L	HP 級 (3µm)		AA 級 (6µm)		一般級 Normal (20µm)	
			訂購編號 Order No.	夾持範圍 Range	訂購編號 Order No.	夾持範圍 Range	訂購編號 Order No.	夾持範圍 Range
ER11	11.3 (11.5)	18 (18)	ER11-1/16" HP	0.043"-0.063"	ER11-1/16" AA	0.043"-0.063"	ER11-1/16"	0.043"-0.063"
			ER11-3/32" HP	0.074"-0.094"	ER11-3/32" AA	0.074"-0.094"	ER11-3/32"	0.074"-0.094"
			ER11-1/8" HP	0.105"-0.125"	ER11-1/8" AA	0.105"-0.125"	ER11-1/8"	0.105"-0.125"
			ER11-5/32" HP	0.137"-0.156"	ER11-5/32" AA	0.137"-0.156"	ER11-5/32"	0.137"-0.156"
			ER11-3/16" HP	0.168"-0.188"	ER11-3/16" AA	0.168"-0.188"	ER11-3/16"	0.168"-0.188"
			ER11-7/32" HP	0.199"-0.219"	ER11-7/32" AA	0.199"-0.219"	ER11-7/32"	0.199"-0.219"
			ER11-1/4" HP	0.23"-0.25"	ER11-1/4" AA	0.23"-0.25"	ER11-1/4"	0.23"-0.25"

• øD x L = 11.3 x 18 (HP/AA) | øD x L = 11.5 x 18 (A/ 一般級 Normal)

MODEL	øD	L	HP 級 (3µm)		AA 級 (6µm)		一般級 Normal (20µm)	
			訂購編號 Order No.	夾持範圍 Range	訂購編號 Order No.	夾持範圍 Range	訂購編號 Order No.	夾持範圍 Range
ER16	17 (17)	27.5 (27)	ER16-1/16" HP	0.043"-0.063"	ER16-1/16" AA	0.043"-0.063"	-	-
			ER16-3/32" HP	0.074"-0.094"	ER16-3/32" AA	0.074"-0.094"	ER16-3/32"	0.074"-0.094"
			ER16-1/8" HP	0.086"-0.125"	ER16-1/8" AA	0.086"-0.125"	ER16-1/8"	0.086"-0.125"
			ER16-5/32" HP	0.117"-0.156"	ER16-5/32" AA	0.117"-0.156"	ER16-5/32"	0.117"-0.156"
			ER16-3/16" HP	0.148"-0.188"	ER16-3/16" AA	0.148"-0.188"	ER16-3/16"	0.148"-0.188"
			ER16-7/32" HP	0.179"-0.219"	ER16-7/32" AA	0.179"-0.219"	ER16-7/32"	0.179"-0.219"
			ER16-1/4" HP	0.21"-0.25"	ER16-1/4" AA	0.21"-0.25"	ER16-1/4"	0.21"-0.25"
			ER16-9/32" HP	0.242"-0.281"	ER16-9/32" AA	0.242"-0.281"	ER16-9/32"	0.242"-0.281"
			ER16-5/16" HP	0.273"-0.313"	ER16-5/16" AA	0.273"-0.313"	ER16-5/16"	0.273"-0.313"
			ER16-11/32" HP	0.304"-0.344"	ER16-11/32" AA	0.304"-0.344"	ER16-11/32"	0.304"-0.344"
			ER16-3/8" HP	0.336"-0.375"	ER16-3/8" AA	0.336"-0.375"	ER16-3/8"	0.336"-0.375"

• øD x L = 17 x 27.5 (HP/AA) | øD x L = 17 x 27 (A/ 一般級 Normal)

MODEL	øD	L	HP 級 (3µm)		AA 級 (6µm)		一般級 Normal (20µm)	
			訂購編號 Order No.	夾持範圍 Range	訂購編號 Order No.	夾持範圍 Range	訂購編號 Order No.	夾持範圍 Range
ER20	21 (21)	31.5 (31)	ER20-1/8" HP	0.086"-0.125"	ER20-1/8" AA	0.086"-0.125"	ER20-1/8"	0.086"-0.125"
			-	-	-	-	ER20-5/32"	0.117"-0.156"
			ER20-3/16" HP	0.148"-0.188"	ER20-3/16" AA	0.148"-0.188"	ER20-3/16"	0.148"-0.188"
			-	-	-	-	ER20-7/32"	0.179"-0.219"
			ER20-1/4" HP	0.21"-0.25"	ER20-1/4" AA	0.21"-0.25"	ER20-1/4"	0.21"-0.25"
			-	-	-	-	ER20-9/32"	0.242"-0.281"
			ER20-5/16" HP	0.273"-0.313"	ER20-5/16" AA	0.273"-0.313"	ER20-5/16"	0.273"-0.313"
			-	-	-	-	ER20-11/32"	0.304"-0.344"
			ER20-3/8" HP	0.336"-0.375"	ER20-3/8" AA	0.336"-0.375"	ER20-3/8"	0.336"-0.375"
			-	-	-	-	ER20-13/32"	0.367"-0.406"
			ER20-7/16" HP	0.399"-0.438"	ER20-7/16" AA	0.399"-0.438"	ER20-7/16"	0.399"-0.438"

• øD x L = 21 x 31.5 (HP/AA) | øD x L = 21 x 31 (A/ 一般級 Normal)



## ER 標準筒夾 (英制) ER Standard Collet (inch)

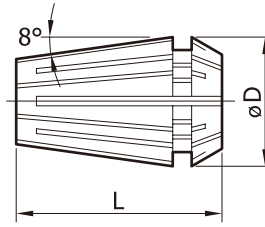

MODEL	øD	L	HP 級 (3μm)		AA 級 (6μm)		一般級 Normal (20μm)	
			訂購編號 Order No.	夾持範圍 Range	訂購編號 Order No.	夾持範圍 Range	訂購編號 Order No.	夾持範圍 Range
ER25	26 (26)	34 (35)	ER25-1/8" HP	0.086"-0.125"	ER25-1/8" AA	0.086"-0.125"	ER25-1/8"	0.086"-0.125"
			-	-	-	-	ER25-5/32"	0.117"-0.156"
			ER25-3/16" HP	0.148"-0.188"	ER25-3/16" AA	0.148"-0.188"	ER25-3/16"	0.148"-0.188"
			-	-	-	-	ER25-7/32"	0.179"-0.219"
			ER25-1/4" HP	0.21"-0.25"	ER25-1/4" AA	0.21"-0.25"	ER25-1/4"	0.21"-0.25"
			-	-	-	-	ER25-9/32"	0.242"-0.281"
			ER25-5/16" HP	0.273"-0.313"	ER25-5/16" AA	0.273"-0.313"	ER25-5/16"	0.273"-0.313"
			-	-	-	-	ER25-11/32"	0.304"-0.344"
			ER25-3/8" HP	0.336"-0.375"	ER25-3/8" AA	0.336"-0.375"	ER25-3/8"	0.336"-0.375"
			-	-	-	-	ER25-13/32"	0.367"-0.406"
			ER25-7/16" HP	0.399"-0.438"	ER25-7/16" AA	0.399"-0.438"	ER25-7/16"	0.399"-0.438"
			-	-	-	-	ER25-15/32"	0.429"-0.468"
ER25-1/2" HP	0.46"-0.5"	ER25-1/2" AA	0.46"-0.5"	ER25-1/2"	0.46"-0.5"			
ER25-9/16" HP	0.523"-0.563"	ER25-9/16" AA	0.523"-0.563"	ER25-9/16"	0.523"-0.563"			
ER25-5/8" HP	0.586"-0.625"	ER25-5/8" AA	0.586"-0.625"	ER25-5/8"	0.586"-0.625"			

• øD x L = 26 x 34 (HP/AA) | øD x L = 26 x 35 (A/ 一般級 Normal)

MODEL	øD	L	HP 級 (3μm)		AA 級 (6μm)		一般級 Normal (20μm)	
			訂購編號 Order No.	夾持範圍 Range	訂購編號 Order No.	夾持範圍 Range	訂購編號 Order No.	夾持範圍 Range
ER32	33	40	ER32-1/8" HP	0.086"-0.125"	ER32-1/8" AA	0.086"-0.125"	ER32-1/8"	0.086"-0.125"
			-	-	-	-	ER32-5/32"	0.117"-0.156"
			ER32-3/16" HP	0.148"-0.188"	ER32-3/16" AA	0.148"-0.188"	ER32-3/16"	0.148"-0.188"
			-	-	-	-	ER32-7/32"	0.179"-0.219"
			ER32-1/4" HP	0.21"-0.25"	ER32-1/4" AA	0.21"-0.25"	ER32-1/4"	0.21"-0.25"
			-	-	-	-	ER32-9/32"	0.242"-0.281"
			ER32-5/16" HP	0.273"-0.313"	ER32-5/16" AA	0.273"-0.313"	ER32-5/16"	0.273"-0.313"
			-	-	-	-	ER32-11/32"	0.304"-0.344"
			ER32-3/8" HP	0.336"-0.375"	ER32-3/8" AA	0.336"-0.375"	ER32-3/8"	0.336"-0.375"
			-	-	-	-	ER32-13/32"	0.367"-0.406"
			ER32-7/16" HP	0.399"-0.438"	ER32-7/16" AA	0.399"-0.438"	ER32-7/16"	0.399"-0.438"
			-	-	-	-	ER32-15/32"	0.429"-0.468"
			ER32-1/2" HP	0.46"-0.5"	ER32-1/2" AA	0.46"-0.5"	ER32-1/2"	0.46"-0.5"
			-	-	-	-	ER32-17/32"	0.492"-0.531"
			ER32-9/16" HP	0.523"-0.563"	ER32-9/16" AA	0.523"-0.563"	ER32-9/16"	0.523"-0.563"
			ER32-5/8" HP	0.586"-0.625"	ER32-5/8" AA	0.586"-0.625"	ER32-5/8"	0.586"-0.625"
			ER32-11/16" HP	0.648"-0.688"	ER32-11/16" AA	0.648"-0.688"	ER32-11/16"	0.648"-0.688"
			ER32-3/4" HP	0.711"-0.75"	ER32-3/4" AA	0.711"-0.75"	ER32-3/4"	0.711"-0.75"
-	-	ER32-13/16" AA	0.773"-0.813"	-	-			

COLLET

# COLLET

## ER 標準筒夾 (英制) ER Standard Collet (inch)

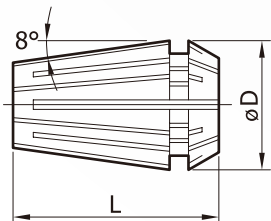

MODEL	øD	L	HP 級 (3μm)		AA 級 (6μm)		一般級 Normal (20 μm)			
			訂購編號 Order No.	夾持範圍 Range	訂購編號 Order No.	夾持範圍 Range	訂購編號 Order No.	夾持範圍 Range		
ER40	41	46	ER40-1/8"	HP	0.086"-0.125"	ER40-1/8"	AA	0.086"-0.125"	ER40-1/8"	0.086"-0.125"
			-	-	-	-	-	ER40-5/32"	0.117"-0.156"	
			ER40-3/16"	HP	0.148"-0.188"	ER40-3/16"	AA	0.148"-0.188"	ER40-3/16"	0.148"-0.188"
			-	-	-	-	-	ER40-7/32"	0.179"-0.219"	
			ER40-1/4"	HP	0.21"-0.25"	ER40-1/4"	AA	0.21"-0.25"	ER40-1/4"	0.21"-0.25"
			-	-	-	-	-	ER40-9/32"	0.242"-0.281"	
			ER40-5/16"	HP	0.273"-0.313"	ER40-5/16"	AA	0.273"-0.313"	ER40-5/16"	0.273"-0.313"
			-	-	-	-	-	ER40-11/32"	0.304"-0.344"	
			ER40-3/8"	HP	0.336"-0.375"	ER40-3/8"	AA	0.336"-0.375"	ER40-3/8"	0.336"-0.375"
			-	-	-	-	-	ER40-13/32"	0.367"-0.406"	
			ER40-7/16"	HP	0.399"-0.438"	ER40-7/16"	AA	0.399"-0.438"	ER40-7/16"	0.399"-0.438"
			-	-	-	-	-	ER40-15/32"	0.429"-0.468"	
			ER40-1/2"	HP	0.46"-0.5"	ER40-1/2"	AA	0.46"-0.5"	ER40-1/2"	0.46"-0.5"
			-	-	-	-	-	ER40-17/32"	0.492"-0.531"	
			ER40-9/16"	HP	0.523"-0.563"	ER40-9/16"	AA	0.523"-0.563"	ER40-9/16"	0.523"-0.563"
			-	-	-	-	-	ER40-19/32"	0.554"-0.594"	
			ER40-5/8"	HP	0.586"-0.625"	ER40-5/8"	AA	0.586"-0.625"	ER40-5/8"	0.586"-0.625"
			-	-	-	-	-	ER40-21/32"	0.617"-0.656"	
			ER40-11/16"	HP	0.648"-0.688"	ER40-11/16"	AA	0.648"-0.688"	ER40-11/16"	0.648"-0.688"
			-	-	-	-	-	ER40-23/32"	0.679"-0.719"	
ER40-3/4"	HP	0.711"-0.75"	ER40-3/4"	AA	0.711"-0.75"	ER40-3/4"	0.711"-0.75"			
ER40-13/16"	HP	0.773"-0.813"	ER40-13/16"	AA	0.773"-0.813"	-	-			
ER40-7/8"	HP	0.836"-0.875"	ER40-7/8"	AA	0.836"-0.875"	ER40-7/8"	0.836"-0.875"			
ER40-1"	HP	0.961"-1"	ER40-1"	AA	0.961"-1"	ER40-1"	0.961"-1"			