

SLE 側固刀把 SIDE LOCK ARBOR

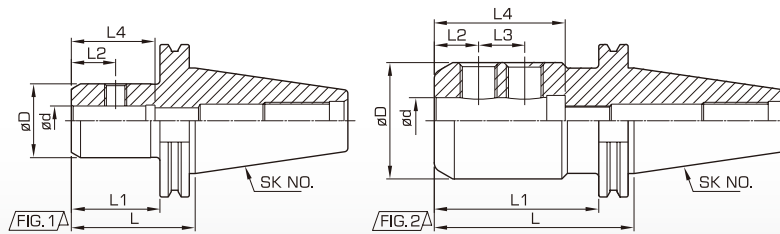

Dimensions / 尺寸標示



page.145



Order No. 訂購編號	FIG	ød	øD	L	L1	L2	L3	L4	Screw 鎖緊螺絲	
SK40	SLE08-075	1	8	28	75	55.9	18	-	40	SLA-M8
	SLE10-075	1	10	35	75	55.9	20	-	50	SLA-M10
	SLE12-075	1	12	42	75	55.9	22.5	-	55	SLA-M12
	SLE16-075	1	16	48	75	55.9	24	-	60	SLA-M12
	SLE20-075	1	20	52	75	55.9	25	-	60	SLA-M16
	SLE25-100	2	25	57	100	80.9	24	25	65	SLA-M16
	SLE32-100	2	32	63	100	80.9	24	28	70	SLA-M16
SK50	SLE10-063	1	10	35	63	43.9	20	-	50	SLA-M10
	SLE12-063	1	12	42	63	43.9	22.5	-	55	SLA-M12
	SLE16-063	1	16	48	63	43.9	24	-	60	SLA-M12
	SLE20-063	1	20	52	63	43.9	25	-	60	SLA-M16
	SLE25-080	2	25	57	80	65.9	24	24	65	SLA-M16
	SLE32-100	2	32	63	100	85.9	24	28	70	SLA-M16
	SLE40-120	2	40	80	120	100.9	30	32	80	SLA-M20
	SLE42-120	2	42	80	120	100.9	30	32	80	SLA-M20

Applications / 應用



Endmilling
銑削